

the MONTGOMERY

1,725 SQUARE FEET OF TOTAL LIVING SPACE

2,205 with optional finished lower level of 480 square feet



INCLUDED FEATURES:

- Open Floor Plan on Three Levels
- Spacious Master Suite with Tray Ceiling and Sitting Area
- Two Full Baths plus Powder Room
- Vaulted Cathedral and Tray Ceilings
- Hardwood Floors on First Floor
- Tile Floors in Baths
- Merillat Classic® Cabinetry
- LG HI-MACS Kitchen Countertops
- GE Profile™ Appliances
- Kohler® Fixtures and Spa Bath
- Central Air Conditioning
- Fireplace with Wood Mantel
- Patio Doors Open to Trex® Decking
- Washer/Dryer Closet with Hookup
- One-Car Garage
- Double-Glazed Low-E Glass Windows
- Maintenance-Free Vinyl Clapboard Siding with Stone Facade
- Architectural Quality Roofing

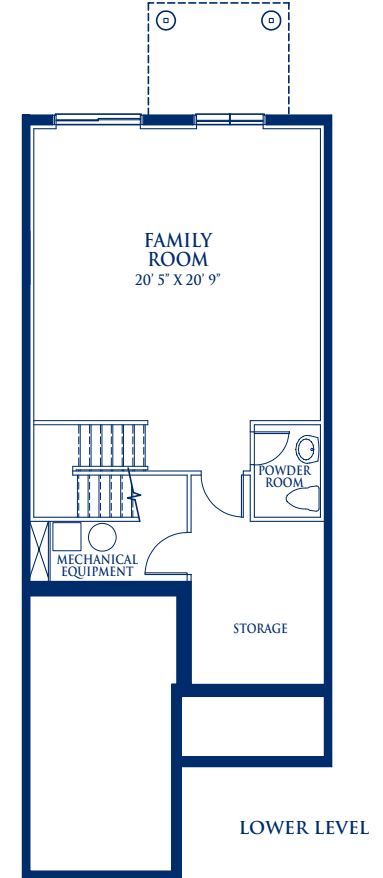
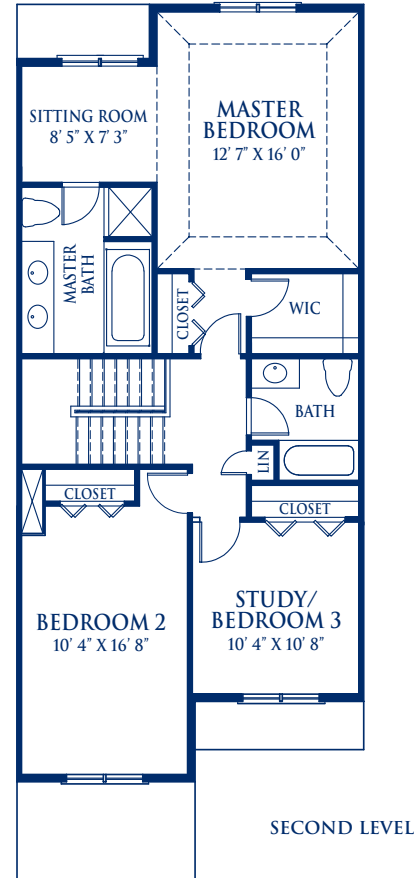
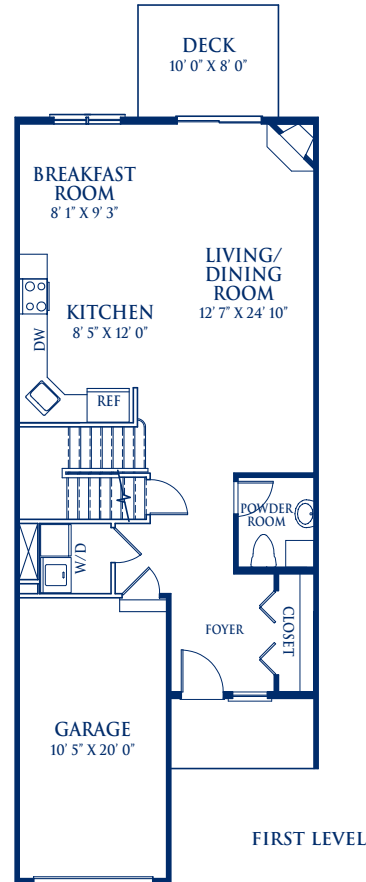

All renderings and floorplans are artist's conceptions. All dimensions, plans and elevations are approximate and subject to field variation.

We reserve the right to make changes due to unforeseen conditions. Floorplans may appear in reverse for some homes. An Equal Housing Opportunity.

This is not an offering. The complete offering terms are in an offering plan available from the Sponsor. File No. H06-0003. Sponsor: Maple Ridge Associates LLC, 261 Hudson View Terrace, Hyde Park, NY, 12538